

APPENDIX 1

Existing Kura student distribution map

Map showing location of TKKM o Takitimu Students as at 1 March 2017

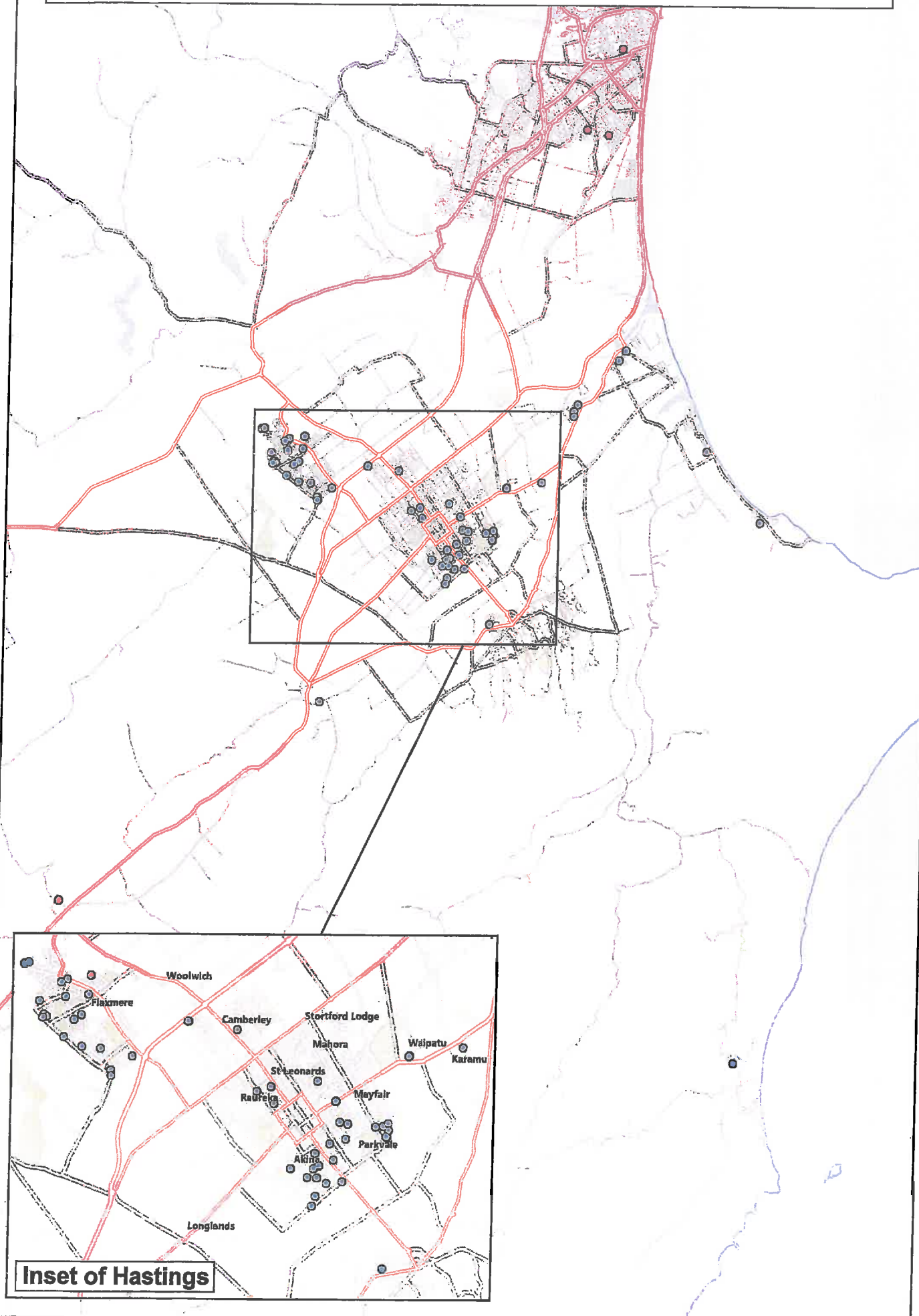

APPENDIX 2

Computer Freehold Register

the 1990s, the number of people in the UK who are aged 65 and over has increased by 1.5 million (1990–1999) and is projected to increase by a further 1.5 million by 2010 (Office of National Statistics 2000).

There is a growing awareness of the need to address the health care needs of the ageing population. The Department of Health (2000) has set out a strategy for the future of health care for older people. The strategy is based on the following principles:

- To ensure that older people have access to the services they need to live as well as possible.
- To ensure that older people are treated as individuals and not as a homogeneous group.
- To ensure that older people are treated with respect and dignity.
- To ensure that older people are treated as equal citizens.

The strategy also sets out a number of key objectives for the future of health care for older people.

- To ensure that older people have access to the services they need to live as well as possible.
- To ensure that older people are treated as individuals and not as a homogeneous group.
- To ensure that older people are treated with respect and dignity.
- To ensure that older people are treated as equal citizens.

The strategy also sets out a number of key objectives for the future of health care for older people.

- To ensure that older people have access to the services they need to live as well as possible.
- To ensure that older people are treated as individuals and not as a homogeneous group.
- To ensure that older people are treated with respect and dignity.
- To ensure that older people are treated as equal citizens.

The strategy also sets out a number of key objectives for the future of health care for older people.

- To ensure that older people have access to the services they need to live as well as possible.
- To ensure that older people are treated as individuals and not as a homogeneous group.
- To ensure that older people are treated with respect and dignity.
- To ensure that older people are treated as equal citizens.

The strategy also sets out a number of key objectives for the future of health care for older people.

- To ensure that older people have access to the services they need to live as well as possible.
- To ensure that older people are treated as individuals and not as a homogeneous group.
- To ensure that older people are treated with respect and dignity.
- To ensure that older people are treated as equal citizens.

The strategy also sets out a number of key objectives for the future of health care for older people.

- To ensure that older people have access to the services they need to live as well as possible.
- To ensure that older people are treated as individuals and not as a homogeneous group.
- To ensure that older people are treated with respect and dignity.
- To ensure that older people are treated as equal citizens.

The strategy also sets out a number of key objectives for the future of health care for older people.

- To ensure that older people have access to the services they need to live as well as possible.
- To ensure that older people are treated as individuals and not as a homogeneous group.
- To ensure that older people are treated with respect and dignity.
- To ensure that older people are treated as equal citizens.



**COMPUTER FREEHOLD REGISTER
UNDER LAND TRANSFER ACT 1952**

Limited as to Parcels

Search Copy



R. W. Muir
Registrar-General
of Land

Identifier **HBB3/462**
Land Registration District **Hawkes Bay**
Date Issued 02 March 1966

Prior References

HB118/147 HBB1/568

Estate Fee Simple
Area 9.2471 hectares more or less
Legal Description Lot 2 Deeds Plan 566 and Lot 2 Deposited
Plan 11280

Proprietors

Aorangi Maori Trust Board

Interests

Subject to Section 36 (4) Counties Amendment Act 1961
9935339.1 Mortgage to Bank of New Zealand - 22.12.2014 at 5:05 pm
10838209.1 Compensation Certificate pursuant to Section 19 Public Works Act 1981 by Her Majesty the Queen -
5.7.2017 at 12:10 pm

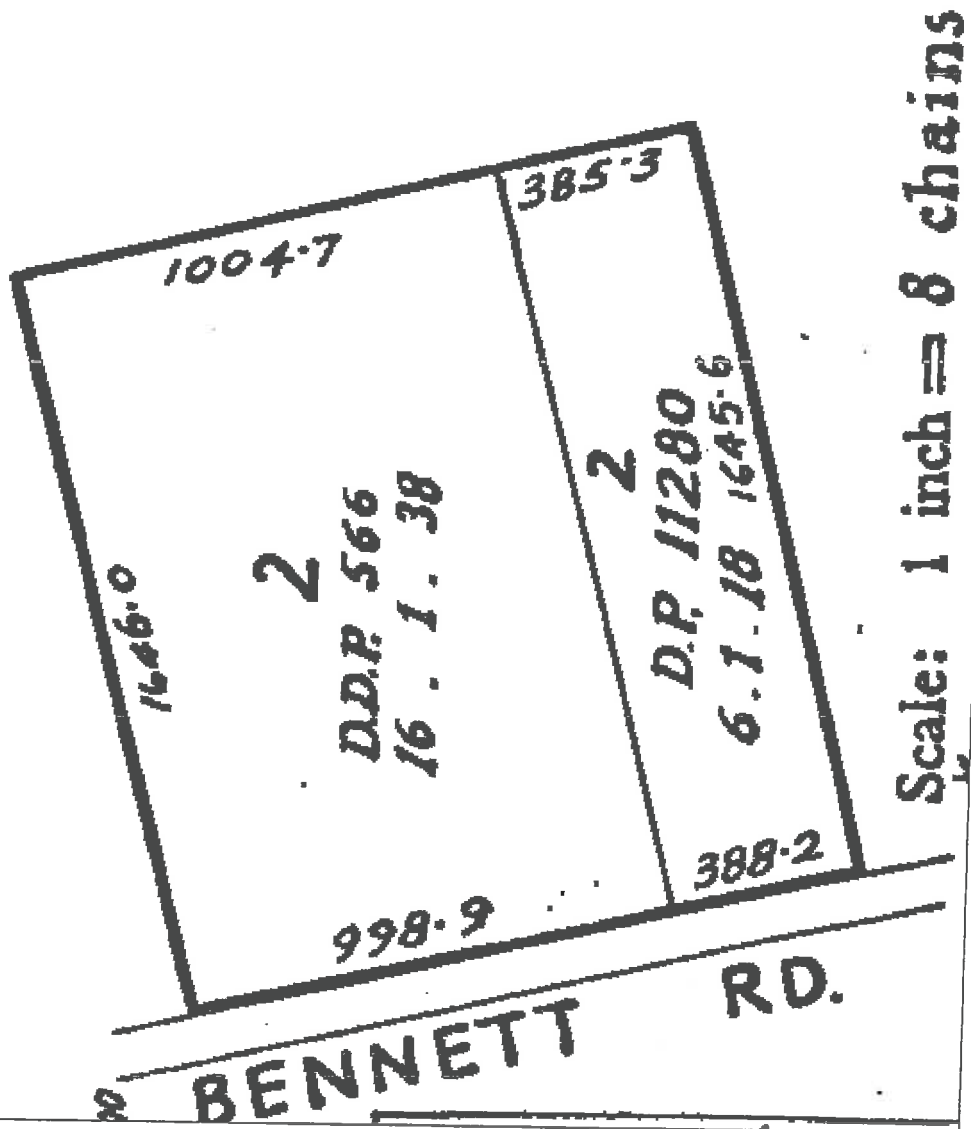

APPENDIX 3

Map of site



APPENDIX 4

Photos of the site

the 1990s, the number of people in the UK who are aged 65 and over has increased by 1.5 million (1990–1999) and is projected to increase by a further 1.5 million by 2010 (Office of National Statistics 2000).

There is a growing awareness of the need to develop strategies to meet the needs of the ageing population. The Department of Health (2000) has identified the need to develop a new paradigm of care for the ageing population, one that is based on the concept of 'active ageing' and 'active living'.

The concept of 'active ageing' is defined by the World Health Organization (WHO) as 'the process of developing and maintaining the functional ability that enables people to participate in society' (WHO 1999). The concept of 'active living' is defined by the Department of Health (2000) as 'the process of developing and maintaining the functional ability that enables people to participate in society'.

The concept of 'active ageing' is based on the idea that people should be able to live independently and participate in society. This means that people should be able to live in their own homes, be able to move around, be able to communicate, and be able to participate in social activities. The concept of 'active living' is based on the idea that people should be able to live independently and participate in society.

The concept of 'active ageing' is based on the idea that people should be able to live independently and participate in society. This means that people should be able to live in their own homes, be able to move around, be able to communicate, and be able to participate in social activities. The concept of 'active living' is based on the idea that people should be able to live independently and participate in society.

The concept of 'active ageing' is based on the idea that people should be able to live independently and participate in society. This means that people should be able to live in their own homes, be able to move around, be able to communicate, and be able to participate in social activities. The concept of 'active living' is based on the idea that people should be able to live independently and participate in society.

The concept of 'active ageing' is based on the idea that people should be able to live independently and participate in society. This means that people should be able to live in their own homes, be able to move around, be able to communicate, and be able to participate in social activities. The concept of 'active living' is based on the idea that people should be able to live independently and participate in society.

The concept of 'active ageing' is based on the idea that people should be able to live independently and participate in society. This means that people should be able to live in their own homes, be able to move around, be able to communicate, and be able to participate in social activities. The concept of 'active living' is based on the idea that people should be able to live independently and participate in society.

The concept of 'active ageing' is based on the idea that people should be able to live independently and participate in society. This means that people should be able to live in their own homes, be able to move around, be able to communicate, and be able to participate in social activities. The concept of 'active living' is based on the idea that people should be able to live independently and participate in society.

The concept of 'active ageing' is based on the idea that people should be able to live independently and participate in society. This means that people should be able to live in their own homes, be able to move around, be able to communicate, and be able to participate in social activities. The concept of 'active living' is based on the idea that people should be able to live independently and participate in society.



The site. View from Bennett Road toward the east. (photo taken 03.07.2017)



View from site frontage toward the adjoining property to the north (120 Bennett Road) (photo taken 03.07.2017)



View from site frontage to the north toward the intersection with Otene Road (photo taken 03.07.2017)



View from site frontage toward the south down Bennett Road (photo taken 03.07.2017)

